

AC-30US - US - CANADA SOCKET



- » US Type
- » Easy for Installation
- » DIN Rail Mount
- » Highly Reliable Performance

2
Years Warranty

DIN Rail Mount



Industrial Grade

CE RoHS COMPLIANT

TECHNICAL PARAMETER

| | |
|-----------------------|------------------------|
| Supply Voltage | 250V AC 50/60 Hz |
| Nominal Current | 13 Amp |
| Mounting | Clip For 35mm Din Rail |
| Grounding | Standard Grounding |
| Type | US / Canada / Japan |
| Material | ABS+PC |
| Fitting Position | Variable |
| Color | White |
| Operating Temperature | -20 To +70°C |
| Weight | 100 gm |
| Dimensions | 76 x 63 x 45 |
| Certification | CE, RoHS Compliance |

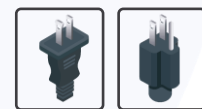
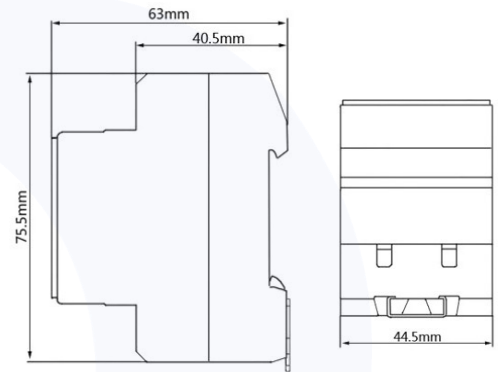
DIMENSIONS



Support Type A & B

OTHER SOCKET



USA

ITALIAN

AUSTRALIA

UK/CANADA

UNIVERSAL

FRANCE

SOUTH AFRICA

GERMAN

2 PIN

